

M23 Signal Panel Mount, Solder, Front mount, Male Housing+Male Thread

- Connector series: M23 Signal
- Contacts: Pin
- Mounting type: Front mount
- Shielding: Unavailable
- Connection Type: Solder
- Part No.: M23-SSPSTFEx***-XXX
Fx refer to Flange joint
*** refers to pins number
XXX for wire type and length

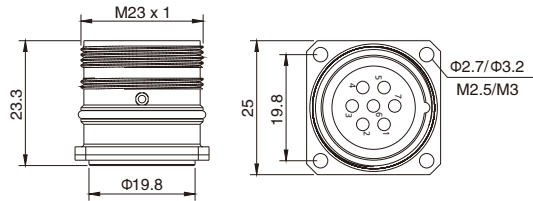

General information



Connector insert:	PA
Connector contacts:	Brass with gold plated
Coupling screw:	Brass with nickel plated
Seal / O-ring:	FKM or NBR
Operation cycles:	>800

Insulation resistance:	$\geq 100M\Omega$
Contact resistance:	$\leq 5m\Omega$
Ambient temperature:	-40°C ~ +125°C
IP rating:	IP68 in locked condition
Assembly Instruction:	Refer to page 413
Panel cut-out:	Refer to page 420

Electrical data & Mechanical data

Number of positions	6,7	9(8+1)/(6+3)		12	16	17	19(16+3)	
Contacts	6,7	8 / 6	1 / 3	12	16	17	16	3
Contact OD(mm)	2.0(14AWG)	1.0(18AWG)	2.0(14AWG)	1.0(18AWG)	1.0(18AWG)	1.0(18AWG)	1.0(18AWG)	1.5(16AWG)
Rated current @ 20°C(A)	20	8	20	8	8	8	8	10
Rated Voltage(V)	300	300	300	300	160	160	160	160
Impulse voltage(V)	2500	2500	2500	1500	1500	1500	1500	1500
Overvoltage category	II							
Pollution Degree	III							

Contacts	Contact OD (mm)	Pin	Part No.	Contacts	Contact OD (mm)	Pin	Part No.
6A	2		M23-SSPSTFEx06A-XXX	12A (Standard)	1		M23-SSPSTFEx12A-XXX
7A	2		M23-SSPSTFEx07A-XXX	12B (opposite)	1		M23-SSPSTFEx12B-XXX
9A (8+1)	8		M23-SSPSTFEx09A-XXX	17A (Standard)	1		M23-SSPSTFEx17A-XXX
	1						
9B (8+1)	8		M23-SSPSTFEx09B-XXX	17B (opposite)	1		M23-SSPSTFEx17B-XXX
	1						
9C (6+3)	6		M23-SSPSTFEx09C-XXX	19A (16+3)	16		M23-SSPSTFEx19A-XXX
	3				3		
16A	1		M23-SSPSTFEx16A-XXX				

Note: Ex refer to Flange joint, X for wire type and length

Remarks

- Please refer to Page 578 for the Conversion between American Wire Gauge AWG and Wire Cross-section mm².
- Please refer to Page 367 for products' part number encoding rule.

M23 Signal Panel Mount, Solder, Front mount, Female Housing + Male Thread

- Connector series: M23 Signal
- Contacts: Socket
- Mounting type: Front mount
- Shielding: Unavailable
- Connection Type: Solder
- Part No.: M23-SSSSTF \underline{Fx} ***-XXX
 Fx refer to Flange joint
 *** refers to pins number
 XXX for wire type and length

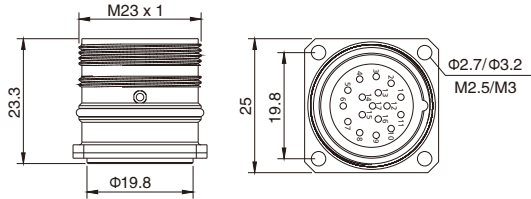

General information



Connector insert:	PA
Connector contacts:	Brass with gold plated
Coupling screw:	Brass with nickel plated
Seal / O-ring:	FKM or NBR
Operation cycles:	>800

Insulation resistance:	≥ 100MΩ
Contact resistance:	≤ 5mΩ
Ambient temperature:	-40°C ~ +125°C
IP rating:	IP68 in locked condition
Assembly Instruction:	Refer to page 413
Panel cut-out:	Refer to page 420

Electrical data & Mechanical data

Number of positions	6,7	9(8+1)/(6+3)		12	16	17	19(16+3)	
Contacts	6,7	8 / 6	1 / 3	12	16	17	16	3
Contact OD(mm)	2.0(14AWG)	1.0(18AWG)	2.0(14AWG)	1.0(18AWG)	1.0(18AWG)	1.0(18AWG)	1.0(18AWG)	1.5(16AWG)
Rated current @ 20°C(A)	20	8	20	8	8	8	8	10
Rated Voltage(V)	300	300	300	300	160	160	160	160
Impulse voltage(V)	2500	2500	2500	1500	1500	1500	1500	1500
Overvoltage category	II							
Pollution Degree	III							

Contacts	Contact OD (mm)	Socket	Part No.	Contacts	Contact OD (mm)	Socket	Part No.
6A	2		M23-SSSSTF \underline{Fx} 06A-XXX	12A (Standard)	1		M23-SSSSTF \underline{Fx} 12A-XXX
7A	2		M23-SSSSTF \underline{Fx} 07A-XXX	12B (opposite)	1		M23-SSSSTF \underline{Fx} 12B-XXX
9A (8+1)	8		M23-SSSSTF \underline{Fx} 09A-XXX	17A (Standard)	1		M23-SSSSTF \underline{Fx} 17A-XXX
	1						
9B (8+1)	8		M23-SSSSTF \underline{Fx} 09B-XXX	17B (opposite)	1		M23-SSSSTF \underline{Fx} 17B-XXX
	1						
9C (6+3)	6		M23-SSSSTF \underline{Fx} 09C-XXX	19A (16+3)	16		M23-SSSSTF \underline{Fx} 19A-XXX
	3				2		
16A	1		M23-SSSSTF \underline{Fx} 16A-XXX				

Note: \underline{Fx} refer to Flange joint, \underline{X} for wire type and length

Remarks

- Please refer to Page 578 for the Conversion between American Wire Gauge AWG and Wire Cross-section mm².
- Please refer to Page 367 for products' part number encoding rule.

M23 Signal Panel Mount, Solder, Rear mount, Male Housing+Male Thread

- Connector series: M23 Signal
- Contacts: Pin
- Mounting type: Rear mount
- Shielding: Unavailable
- Connection Type: Solder
- Part No.: M23-SSPSTR_{Fx}***-XXX
Fx refer to Flange joint
*** refers to pins number
XXX for wire type and length

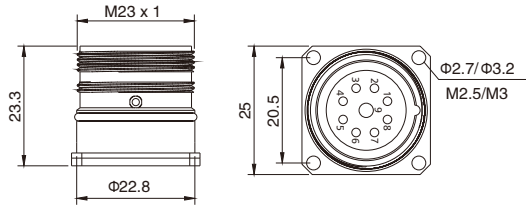

General information



Connector insert:	PA
Connector contacts:	Brass with gold plated
Coupling screw:	Brass with nickel plated
Seal / O-ring:	FKM or NBR
Operation cycles:	>800

Insulation resistance:	$\geq 100M\Omega$
Contact resistance:	$\leq 5m\Omega$
Ambient temperature:	-40°C ~ +125°C
IP rating:	IP68 in locked condition
Assembly Instruction:	Refer to page 413
Panel cut-out:	Refer to page 420

Electrical data & Mechanical data

Number of positions	6,7	9(8+1)/(6+3)		12	16	17	19(16+3)	
Contacts	6,7	8 / 6	1 / 3	12	16	17	16	3
Contact OD(mm)	2.0(14AWG)	1.0(18AWG)	2.0(14AWG)	1.0(18AWG)	1.0(18AWG)	1.0(18AWG)	1.0(18AWG)	1.5(16AWG)
Rated current @ 20°C(A)	20	8	20	8	8	8	8	10
Rated Voltage(V)	300	300	300	300	160	160	160	160
Impulse voltage(V)	2500	2500	2500	1500	1500	1500	1500	1500
Overvoltage category	II							
Pollution Degree	III							

Contacts	Contact OD (mm)	Pin	Part No.	Contacts	Contact OD (mm)	Pin	Part No.
6A	2		M23-SSPSTR _{Fx} 06A-XXX	12A (Standard)	1		M23-SSPSTR _{Fx} 12A-XXX
7A	2		M23-SSPSTR _{Fx} 07A-XXX	12B (opposite)	1		M23-SSPSTR _{Fx} 12B-XXX
9A (8+1)	8		M23-SSPSTR _{Fx} 09A-XXX	17A (Standard)	1		M23-SSPSTR _{Fx} 17A-XXX
	1						
9B (8+1)	8		M23-SSPSTR _{Fx} 09B-XXX	17B (opposite)	1		M23-SSPSTR _{Fx} 17B-XXX
	1						
9C (6+3)	6		M23-SSPSTR _{Fx} 09C-XXX	19A (16+3)	16		M23-SSPSTR _{Fx} 19A-XXX
	3				2		
16A	1		M23-SSPSTR _{Fx} 16A-XXX				

Note: _{Fx} refer to Flange joint, _X for wire type and length

Remarks

- Please refer to Page 578 for the Conversion between American Wire Gauge AWG and Wire Cross-section mm².
- Please refer to Page 367 for products' part number encoding rule.

M23 Signal Panel Mount, Solder, Rear mount, Female Housing + Male Thread

- Connector series: M23 Signal
- Contacts: Socket
- Mounting type: Rear mount
- Shielding: Unavailable
- Connection Type: Solder
- Part No.: M23-SSSSTR_{Fx}***-XXX

Fx refer to Flange joint
 *** refers to pins number
 XXX for wire type and length

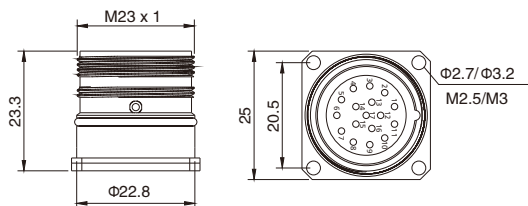

General information



Connector insert:	PA
Connector contacts:	Brass with gold plated
Coupling screw:	Brass with nickel plated
Seal / O-ring:	FKM or NBR
Operation cycles:	>800

Insulation resistance:	≥ 100MΩ
Contact resistance:	≤ 5mΩ
Ambient temperature:	-40°C ~ +125°C
IP rating:	IP68 in locked condition
Assembly Instruction:	Refer to page 413
Panel cut-out:	Refer to page 420

Electrical data & Mechanical data

Number of positions	6,7	9(8+1)/(6+3)		12	16	17	19(16+3)	
Contacts	6,7	8 / 6	1 / 3	12	16	17	16	3
Contact OD(mm)	2.0(14AWG)	1.0(18AWG)	2.0(14AWG)	1.0(18AWG)	1.0(18AWG)	1.0(18AWG)	1.0(18AWG)	1.5(16AWG)
Rated current @ 20°C(A)	20	8	20	8	8	8	8	10
Rated Voltage(V)	300	300	300	300	160	160	160	160
Impulse voltage(V)	2500	2500	2500	1500	1500	1500	1500	1500
Overvoltage category	II							
Pollution Degree	III							

Contacts	Contact OD (mm)	Socket	Part No.	Contacts	Contact OD (mm)	Socket	Part No.
6A	2		M23-SSSSTR _{Fx} 06A-XXX	12A (Standard)	1		M23-SSSSTR _{Fx} 12A-XXX
7A	2		M23-SSSSTR _{Fx} 07A-XXX	12B (opposite)	1		M23-SSSSTR _{Fx} 12B-XXX
9A (8+1)	8		M23-SSSSTR _{Fx} 09A-XXX	17A (Standard)	1		M23-SSSSTR _{Fx} 17A-XXX
	1						
9B (8+1)	8		M23-SSSSTR _{Fx} 09B-XXX	17B (opposite)	1		M23-SSSSTR _{Fx} 17B-XXX
	1						
9C (6+3)	6		M23-SSSSTR _{Fx} 09C-XXX	19A (16+3)	16		M23-SSSSTR _{Fx} 19A-XXX
	3				2		
16A	1		M23-SSSSTR _{Fx} 16A-XXX				

Note: _{Fx} refer to Flange joint, _X for wire type and length

Remarks

- Please refer to Page 578 for the Conversion between American Wire Gauge AWG and Wire Cross-section mm².
- Please refer to Page 367 for products' part number encoding rule.

M23 Signal Panel Mount, Solder, Rear mount, Male Housing + Male Thread

- Connector series: M23 Signal
- Contacts: Pin
- Mounting type: Rear mount
- Shielding: Unavailable
- Connection Type: Solder
- Part No.: M23-SSPSTR_{Sx}***-XXX
Sx refer to Screw joint
*** refers to pins number
XXX for wire type and length

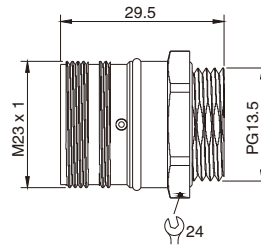

General information



Connector insert:	PA
Connector contacts:	Brass with gold plated
Coupling screw:	Brass with nickel plated
Seal / O-ring:	FKM or NBR
Operation cycles:	>800

Insulation resistance:	≥ 100MΩ
Contact resistance:	≤ 5mΩ
Ambient temperature:	-40°C ~ +125°C
IP rating:	IP68 in locked condition
Assembly Instruction:	Refer to page 413
Panel cut-out:	Refer to page 420

Electrical data & Mechanical data

Number of positions	6,7	9(8+1)/(6+3)		12	16	17	19(16+3)	
Contacts	6,7	8 / 6	1 / 3	12	16	17	16	3
Contact OD(mm)	2.0(14AWG)	1.0(18AWG)	2.0(14AWG)	1.0(18AWG)	1.0(18AWG)	1.0(18AWG)	1.0(18AWG)	1.5(16AWG)
Rated current @ 20°C(A)	20	8	20	8	8	8	8	10
Rated Voltage(V)	300	300	300	300	160	160	160	160
Impulse voltage(V)	2500	2500	2500	1500	1500	1500	1500	1500
Overvoltage category	II							
Pollution Degree	III							

Contacts	Contact OD (mm)	Pin	Part No.	Contacts	Contact OD (mm)	Pin	Part No.
6A	2		M23-SSPSTR _{Sx} 06A-XXX	12A (Standard)	1		M23-SSPSTR _{Sx} 12A-XXX
7A	2		M23-SSPSTR _{Sx} 07A-XXX	12B (opposite)	1		M23-SSPSTR _{Sx} 12B-XXX
9A (8+1)	8		M23-SSPSTR _{Sx} 09A-XXX	17A (Standard)	1		M23-SSPSTR _{Sx} 17A-XXX
	1						
9B (8+1)	8		M23-SSPSTR _{Sx} 09B-XXX	17B (opposite)	1		M23-SSPSTR _{Sx} 17B-XXX
	1						
9C (6+3)	6		M23-SSPSTR _{Sx} 09C-XXX	19A (16+3)	16		M23-SSPSTR _{Sx} 19A-XXX
	3				2		
16A	1		M23-SSPSTR _{Sx} 16A-XXX				

Note: Sx refer to Screw joint, X for wire type and length

Remarks

- Please refer to Page 578 for the Conversion between American Wire Gauge AWG and Wire Cross-section mm².
- Please refer to Page 367 for products' part number encoding rule.

M23 Signal Panel Mount, Solder, Rear mount, Female Housing + Male Thread

- Connector series: M23 Signal
- Contacts: Socket
- Mounting type: Rear mount
- Shielding: Unavailable
- Connection Type: Solder
- Part No.: M23-SSSSTR_{Sx}***-XXX
 Sx refer to Screw joint
 *** refers to pins number
 XXX for wire type and length

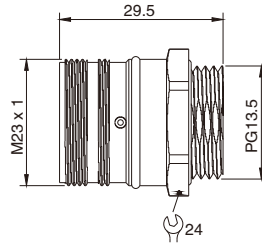

General information



Connector insert:	PA
Connector contacts:	Brass with gold plated
Coupling screw:	Brass with nickel plated
Seal / O-ring:	FKM or NBR
Operation cycles:	>800

Insulation resistance:	≥ 100MΩ
Contact resistance:	≤ 5mΩ
Ambient temperature:	-40°C ~ +125°C
IP rating:	IP68 in locked condition
Assembly Instruction:	Refer to page 413
Panel cut-out:	Refer to page 420

Electrical data & Mechanical data

Number of positions	6,7	9(8+1)/(6+3)		12	16	17	19(16+3)	
Contacts	6,7	8 / 6	1 / 3	12	16	17	16	3
Contact OD(mm)	2.0(14AWG)	1.0(18AWG)	2.0(14AWG)	1.0(18AWG)	1.0(18AWG)	1.0(18AWG)	1.0(18AWG)	1.5(16AWG)
Rated current @ 20°C(A)	20	8	20	8	8	8	8	10
Rated Voltage(V)	300	300	300	300	160	160	160	160
Impulse voltage(V)	2500	2500	2500	1500	1500	1500	1500	1500
Overvoltage category	II							
Pollution Degree	III							

Contacts	Contact OD (mm)	Socket	Part No.	Contacts	Contact OD (mm)	Socket	Part No.
6A	2		M23-SSSSTR _{Sx} 06A-XXX	12A (Standard)	1		M23-SSSSTR _{Sx} 12A-XXX
7A	2		M23-SSSSTR _{Sx} 07A-XXX	12B (opposite)	1		M23-SSSSTR _{Sx} 12B-XXX
9A (8+1)	8		M23-SSSSTR _{Sx} 09A-XXX	17A (Standard)	1		M23-SSSSTR _{Sx} 17A-XXX
	1						
9B (8+1)	8		M23-SSSSTR _{Sx} 09B-XXX	17B (opposite)	1		M23-SSSSTR _{Sx} 17B-XXX
	1						
9C (6+3)	6		M23-SSSSTR _{Sx} 09C-XXX	19A (16+3)	16		M23-SSSSTR _{Sx} 19A-XXX
	3				2		
16A	1		M23-SSSSTR _{Sx} 16A-XXX				

Note: Sx refer to Screw joint, X for wire type and length

Remarks

- Please refer to Page 578 for the Conversion between American Wire Gauge AWG and Wire Cross-section mm².
- Please refer to Page 367 for products' part number encoding rule.

M23 Signal Panel Mount, Solder, Front mount, Male Housing+Male Thread

- Connector series: M23 Signal
- Contacts: Pin
- Mounting type: Front mount
- Shielding: Unshielded
- Connection Type: Solder
- Part No.: M23-SSPSTF_{Sx}***

*** refers to pins number
Sx refer to Flange joint

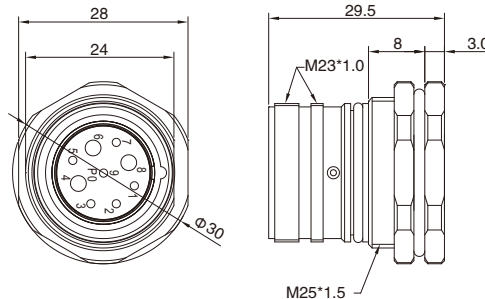

General information



Connector insert:	PA
Connector contacts:	Brass with gold plated
Coupling screw:	Brass with nickel plated
Seal / O-ring:	FKM or NBR
Operation cycles:	>800

Insulation resistance:	≥ 100MΩ
Contact resistance:	≤ 5mΩ
Ambient temperature:	-40°C ~ +125°C
IP rating:	IP68 in locked condition
Assembly Instruction:	Refer to page 413
Panel cut-out:	Refer to page 420

Electrical data & Mechanical data

Number of positions	6,7	9(8+1)/(6+3)		12	16	17	19(16+3)	
Contacts	6,7	8 / 6	1 / 3	12	16	17	16	3
Contact OD(mm)	2.0(14AWG)	1.0(18AWG)	2.0(14AWG)	1.0(18AWG)	1.0(18AWG)	1.0(18AWG)	1.0(18AWG)	1.5(16AWG)
Rated current @ 20°C(A)	20	8	20	8	8	8	8	10
Rated Voltage(V)	300	300	300	300	160	160	160	160
Impulse voltage(V)	2500	2500	2500	1500	1500	1500	1500	1500
Overvoltage category	II							
Pollution Degree	III							

Contacts	Contact OD (mm)	Pin	Part No.	Contacts	Contact OD (mm)	Pin	Part No.
6A	2		M23-SSPSTF _{Sx} 06A	12A (Standard)	1		M23-SSPSTF _{Sx} 12A
7A	2		M23-SSPSTF _{Sx} 07A	12B (opposite)	1		M23-SSPSTF _{Sx} 12B
9A (8+1)	8		M23-SSPSTF _{Sx} 09A	17A (Standard)	1		M23-SSPSTF _{Sx} 17A
	1						
9B (8+1)	8		M23-SSPSTF _{Sx} 09B	17B (opposite)	1		M23-SSPSTF _{Sx} 17B
	1						
9C (6+3)	6		M23-SSPSTF _{Sx} 09C	19A (16+3)	16		M23-SSPSTF _{Sx} 19A
	3				3		
16A	1		M23-SSPSTF _{Sx} 16A				

Note: _{Sx} refer to Flange joint

Remarks

- Please refer to Page 578 for the Conversion between American Wire Gauge AWG and Wire Cross-section mm².
- Please refer to Page 367 for products' part number encoding rule.

M23 Signal Panel Mount, Solder, Front mount, Female Housing + Male Thread

- Connector series: M23 Signal
- Contacts: Socket
- Mounting type: Front mount
- Shielding: Unshielded
- Connection Type: Solder
- Part No.: M23-SSSSTFS_x***

*** refers to pins number
Sx refer to Flange joint

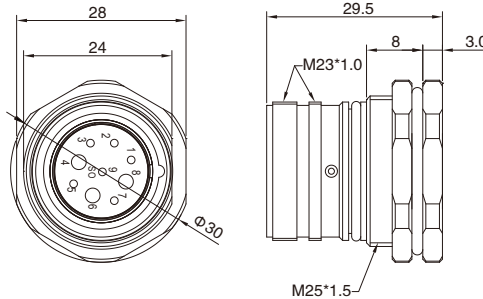

General information



Connector insert:	PA
Connector contacts:	Brass with gold plated
Coupling screw:	Brass with nickel plated
Seal / O-ring:	FKM or NBR
Operation cycles:	>800

Insulation resistance:	≥ 100MΩ
Contact resistance:	≤ 5mΩ
Ambient temperature:	-40°C ~ +125°C
IP rating:	IP68 in locked condition
Assembly Instruction:	Refer to page 413
Panel cut-out:	Refer to page 420

Electrical data & Mechanical data

Number of positions	6,7	9(8+1)/(6+3)		12	16	17	19(16+3)	
Contacts	6,7	8 / 6	1 / 3	12	16	17	16	3
Contact OD(mm)	2.0(14AWG)	1.0(18AWG)	2.0(14AWG)	1.0(18AWG)	1.0(18AWG)	1.0(18AWG)	1.0(18AWG)	1.5(16AWG)
Rated current @ 20°C(A)	20	8	20	8	8	8	8	10
Rated Voltage(V)	300	300	300	300	160	160	160	160
Impulse voltage(V)	2500	2500	2500	1500	1500	1500	1500	1500
Overvoltage category	II							
Pollution Degree	III							

Contacts	Contact OD (mm)	Socket	Part No.	Contacts	Contact OD (mm)	Socket	Part No.
6A	2		M23-SSSSTFS _x 06A	12A (Standard)	1		M23-SSSSTFS _x 12A
7A	2		M23-SSSSTFS _x 07A	12B (opposite)	1		M23-SSSSTFS _x 12B
9A (8+1)	8		M23-SSSSTFS _x 09A	17A (Standard)	1		M23-SSSSTFS _x 17A
	1						
9B (8+1)	8		M23-SSSSTFS _x 09B	17B (opposite)	1		M23-SSSSTFS _x 17B
	1						
9C (6+3)	6		M23-SSSSTFS _x 09C	19A (16+3)	1		M23-SSSSTFS _x 19A
	3						
16A	1		M23-SSSSTFS _x 16A				

Note: S_x refer to Flange joint

Remarks

- Please refer to Page 578 for the Conversion between American Wire Gauge AWG and Wire Cross-section mm².
- Please refer to Page 367 for products' part number encoding rule.

M23 Signal Panel Mount, PCB, Front mount, Male Housing+Male Thread

- Connector series: M23 Signal
- Contacts: Pin
- Mounting type: Front mount
- Shielding: Unshielded
- Connection Type: PCB
- Part No.: M23-SSPPSTFS2***

*** refers to pins number

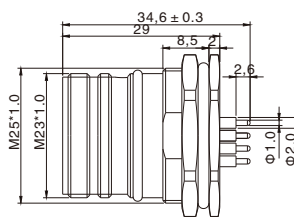
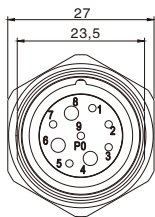

General information

Connector insert:	PA
Connector contacts:	Brass with gold plated
Coupling screw:	Brass with nickel plated
Seal / O-ring:	FKM or NBR
Operation cycles:	>800

Insulation resistance:	≥ 100MΩ
Contact resistance:	≤ 5mΩ
Ambient temperature:	-40°C ~ +125°C
IP rating:	IP68 in locked condition
Panel cut-out:	Refer to page 420
PCB layout:	Refer to page 420

Electrical data & Mechanical data

Number of positions	6,7	9(8+1)/(6+3)		12	16	17	19(16+3)	
Contacts	6,7	8 / 6	1 / 3	12	16	17	16	3
Contact OD(mm)	2.0(14AWG)	1.0(18AWG)	2.0(14AWG)	1.0(18AWG)	1.0(18AWG)	1.0(18AWG)	1.0(18AWG)	1.5(16AWG)
Rated current @ 20°C(A)	20	8	20	8	8	8	8	10
Rated Voltage(V)	300	300	300	300	160	160	160	160
Impulse voltage(V)	2500	2500	2500	1500	1500	1500	1500	1500
Overvoltage category	II							
Pollution Degree	III							

Contacts	Contact OD (mm)	Pin	Part No.	Contacts	Contact OD (mm)	Pin	Part No.
6A	2		M23-SSPPSTFS206A	12A (Standard)	1		M23-SSPPSTFS212A
7A	2		M23-SSPPSTFS207A	12B (opposite)	1		M23-SSPPSTFS212B
9A (8+1)	8		M23-SSPPSTFS209A	17A (Standard)	1		M23-SSPPSTFS217A
	1						
9B (8+1)	8		M23-SSPPSTFS209B	17B (opposite)	1		M23-SSPPSTFS217B
	1						
9C (6+3)	6		M23-SSPPSTFS209C	19A (16+3)	16		M23-SSPPSTFS219A
	3				3		
16A	1		M23-SSPPSTFS216A				

Remarks

- Please refer to Page 578 for the Conversion between American Wire Gauge AWG and Wire Cross-section mm².
- Please refer to Page 367 for products' part number encoding rule.

M23 Signal Panel Mount, PCB, Front mount, Female Housing+Male Thread

- Connector series: M23 Signal
- Contacts: Socket
- Mounting type: Front mount
- Shielding: Unshielded
- Connection Type: PCB
- Part No.: M23-SSPSSTFS2***

*** refers to pins number

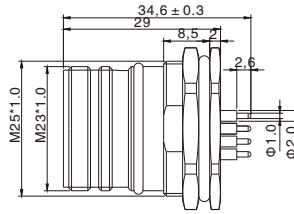
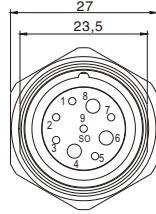

General information

Connector insert:	PA
Connector contacts:	Brass with gold plated
Coupling screw:	Brass with nickel plated
Seal / O-ring:	FKM or NBR
Operation cycles:	>800

Insulation resistance:	≥ 100MΩ
Contact resistance:	≤ 5mΩ
Ambient temperature:	-40°C ~ +125°C
IP rating:	IP68 in locked condition
Panel cut-out:	Refer to page 420
PCB layout:	Refer to page 420

Electrical data & Mechanical data

Number of positions	6,7	9(8+1)/(6+3)		12	16	17	19(16+3)	
Contacts	6,7	8 / 6	1 / 3	12	16	17	16	3
Contact OD(mm)	2.0(14AWG)	1.0(18AWG)	2.0(14AWG)	1.0(18AWG)	1.0(18AWG)	1.0(18AWG)	1.0(18AWG)	1.5(16AWG)
Rated current @ 20°C(A)	20	8	20	8	8	8	8	10
Rated Voltage(V)	300	300	300	300	160	160	160	160
Impulse voltage(V)	2500	2500	2500	1500	1500	1500	1500	1500
Overvoltage category	II							
Pollution Degree	III							

Contacts	Contact OD (mm)	Socket	Part No.	Contacts	Contact OD (mm)	Socket	Part No.
6A	2		M23-SSPSSTFS206A	12A (Standard)	1		M23-SSPSSTFS212A
7A	2		M23-SSPSSTFS207A	12B (opposite)	1		M23-SSPSSTFS212B
9A (8+1)	8		M23-SSPSSTFS209A	17A (Standard)	1		M23-SSPSSTFS217A
	1						
9B (8+1)	8		M23-SSPSSTFS209B	17B (opposite)	1		M23-SSPSSTFS217B
	1						
9C (6+3)	6		M23-SSPSSTFS209C	19A (16+3)	16		M23-SSPSSTFS219A
	3				2		
16A	1		M23-SSPSSTFS216A				

Remarks

- Please refer to Page 578 for the Conversion between American Wire Gauge AWG and Wire Cross-section mm².
- Please refer to Page 367 for products' part number encoding rule.

M23 Signal Panel Mount, PCB, Front mount, Male Housing+Male Thread

- Connector series: M23 Signal
- Contacts: Pin
- Mounting type: Front mount
- Shielding: Unshielded
- Connection Type: PCB
- Part No.: M23-SSPPSTFFx***

*** refers to pins number
Fx refer to Flange joint

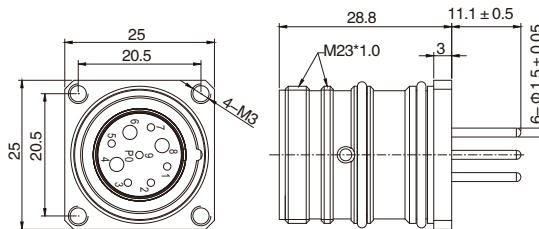

General information

Connector insert:	PA
Connector contacts:	Brass with gold plated
Coupling screw:	Brass with nickel plated
Seal / O-ring:	FKM or NBR
Operation cycles:	>800

Insulation resistance:	≥ 100MΩ
Contact resistance:	≤ 5mΩ
Ambient temperature:	-40°C ~ +125°C
IP rating:	IP68 in locked condition
Panel cut-out:	Refer to page 420
PCB layout:	Refer to page 420

Electrical data & Mechanical data

Number of positions	6,7	9(8+1)/(6+3)		12	16	17	19(16+3)	
Contacts	6,7	8 / 6	1 / 3	12	16	17	16	3
Contact OD(mm)	2.0(14AWG)	1.0(18AWG)	2.0(14AWG)	1.0(18AWG)	1.0(18AWG)	1.0(18AWG)	1.0(18AWG)	1.5(16AWG)
Rated current @ 20°C(A)	20	8	20	8	8	8	8	10
Rated Voltage(V)	300	300	300	300	160	160	160	160
Impulse voltage(V)	2500	2500	2500	1500	1500	1500	1500	1500
Overvoltage category	II							
Pollution Degree	III							

Contacts	Contact OD (mm)	Pin	Part No.	Contacts	Contact OD (mm)	Pin	Part No.
6A	2		M23-SSPPSTFFx06A	12A (Standard)	1		M23-SSPPSTFFx12A
7A	2		M23-SSPPSTFFx07A	12B (opposite)	1		M23-SSPPSTFFx12B
9A (8+1)	8		M23-SSPPSTFFx09A	17A (Standard)	1		M23-SSPPSTFFx17A
	1						
9B (8+1)	8		M23-SSPPSTFFx09B	17B (opposite)	1		M23-SSPPSTFFx17B
	1						
9C (6+3)	6		M23-SSPPSTFFx09C	19A (16+3)	16		M23-SSPPSTFFx19A
	3				2		
16A	1		M23-SSPPSTFFx16A				

Note: Fx refer to Flange joint

Remarks

- Please refer to Page 578 for the Conversion between American Wire Gauge AWG and Wire Cross-section mm².
- Please refer to Page 367 for products' part number encoding rule.

M23 Signal Panel Mount, PCB, Front mount, Female Housing+Male Thread

- Connector series: M23 Signal
- Contacts: Socket
- Mounting type: Front mount
- Shielding: Unshielded
- Connection Type: PCB
- Part No.: M23-SSPSSTFFx***

*** refers to pins number
Fx refer to Flange joint

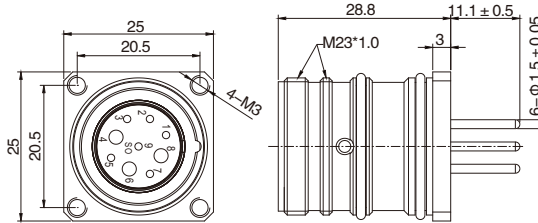

General information

Connector insert:	PA
Connector contacts:	Brass with gold plated
Coupling screw:	Brass with nickel plated
Seal / O-ring:	FKM or NBR
Operation cycles:	>800

Insulation resistance:	≥ 100MΩ
Contact resistance:	≤ 5mΩ
Ambient temperature:	-40°C ~ +125°C
IP rating:	IP68 in locked condition
Panel cut-out:	Refer to page 420
PCB layout:	Refer to page 420

Electrical data & Mechanical data

Number of positions	6,7	9(8+1)/(6+3)		12	16	17	19(16+3)	
Contacts	6,7	8 / 6	1 / 3	12	16	17	16	3
Contact OD(mm)	2.0(14AWG)	1.0(18AWG)	2.0(14AWG)	1.0(18AWG)	1.0(18AWG)	1.0(18AWG)	1.0(18AWG)	1.5(16AWG)
Rated current @ 20°C(A)	20	8	20	8	8	8	8	10
Rated Voltage(V)	300	300	300	300	160	160	160	160
Impulse voltage(V)	2500	2500	2500	1500	1500	1500	1500	1500
Overvoltage category	II							
Pollution Degree	III							

Contacts	Contact OD (mm)	Socket	Part No.	Contacts	Contact OD (mm)	Socket	Part No.
6A	2		M23-SSPSSTFFx06A	12A (Standard)	1		M23-SSPSSTFFx12A
7A	2		M23-SSPSSTFFx07A	12B (opposite)	1		M23-SSPSSTFFx12B
9A (8+1)	8		M23-SSPSSTFFx09A	17A (Standard)	1		M23-SSPSSTFFx17A
	1						
9B (8+1)	8		M23-SSPSSTFFx09B	17B (opposite)	1		M23-SSPSSTFFx17B
	1						
9C (6+3)	6		M23-SSPSSTFFx09C	19A (16+3)	16		M23-SSPSSTFFx19A
	3				2		
16A	1		M23-SSPSSTFFx16A				

Note: Fx refer to Flange joint

Remarks

- Please refer to Page 578 for the Conversion between American Wire Gauge AWG and Wire Cross-section mm².
- Please refer to Page 367 for products' part number encoding rule.

M23 Signal Panel Mount, Crimp, Front mount, Male Housing+Male Thread

- Connector series: M23 Signal
- Contacts: Pin
- Mounting type: Front mount
- Shielding: Unshielded
- Connection Type: Crimp
- Part No.: M23-SSCPSTF_{Sx}***

*** refers to pins number
Sx refer to Flange joint

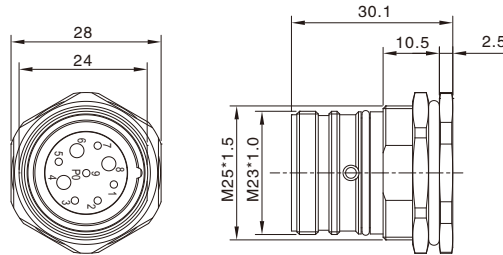

General information



Connector insert:	PA
Connector contacts:	Brass with gold plated
Coupling screw:	Brass with nickel plated
Seal / O-ring:	FKM or NBR
Operation cycles:	>800

Insulation resistance:	≥ 100MΩ
Contact resistance:	≤ 5mΩ
Ambient temperature:	-40°C ~ +125°C
IP rating:	IP68 in locked condition
Panel cut-out:	Refer to page 420

Electrical data & Mechanical data

Number of positions	6,7	9(8+1)/(6+3)		12	16	17	19(16+3)	
Contacts	6,7	8 / 6	1 / 3	12	16	17	16	3
Contact OD(mm)	2.0(14AWG)	1.0(18AWG)	2.0(14AWG)	1.0(18AWG)	1.0(18AWG)	1.0(18AWG)	1.0(18AWG)	1.5(16AWG)
Rated current @ 20°C(A)	20	8	20	8	8	8	8	10
Rated Voltage(V)	300	300	300	300	160	160	160	160
Impulse voltage(V)	2500	2500	2500	1500	1500	1500	1500	1500
Overvoltage category	II							
Pollution Degree	III							

Contacts	Contact OD (mm)	Pin	Part No.	Contacts	Contact OD (mm)	Pin	Part No.
6A	2		M23-SSCPSTF _{Sx} 06A	12A (Standard)	1		M23-SSCPSTF _{Sx} 12A
7A	2		M23-SSCPSTF _{Sx} 07A	12B (opposite)	1		M23-SSCPSTF _{Sx} 12B
9A (8+1)	8		M23-SSCPSTF _{Sx} 09A	17A (Standard)	1		M23-SSCPSTF _{Sx} 17A
	1						
9B (8+1)	8		M23-SSCPSTF _{Sx} 09B	17B (opposite)	1		M23-SSCPSTF _{Sx} 17B
	1						
9C (6+3)	6		M23-SSCPSTF _{Sx} 09C	19A (16+3)	16		M23-SSCPSTF _{Sx} 19A
	3				2		
16A	1		M23-SSCPSTF _{Sx} 16A				

Note: _{Sx} refer to Flange joint

Remarks

- Please refer to Page 578 for the Conversion between American Wire Gauge AWG and Wire Cross-section mm².
- Please refer to Page 367 for products' part number encoding rule.

M23 Signal Panel Mount, Crimp, Front mount, Female Housing+Male Thread

- Connector series: M23 Signal
- Contacts: Socket
- Mounting type: Front mount
- Shielding: Unshielded
- Connection Type: Crimp
- Part No.: M23-SSCSSTFS_x***

*** refers to pins number
Sx refer to Screw joint

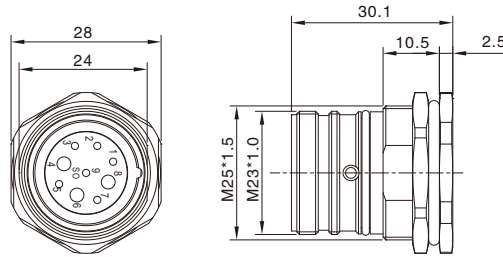

General information



Connector insert:	PA
Connector contacts:	Brass with gold plated
Coupling screw:	Brass with nickel plated
Seal / O-ring:	FKM or NBR
Operation cycles:	>800

Insulation resistance:	≥ 100MΩ
Contact resistance:	≤ 5mΩ
Ambient temperature:	-40°C ~ +125°C
IP rating:	IP68 in locked condition
Panel cut-out:	Refer to page 420

Electrical data & Mechanical data

Number of positions	6,7	9(8+1)/(6+3)		12	16	17	19(16+3)	
Contacts	6,7	8 / 6	1 / 3	12	16	17	16	3
Contact OD(mm)	2.0(14AWG)	1.0(18AWG)	2.0(14AWG)	1.0(18AWG)	1.0(18AWG)	1.0(18AWG)	1.0(18AWG)	1.5(16AWG)
Rated current @ 20°C(A)	20	8	20	8	8	8	8	10
Rated Voltage(V)	300	300	300	300	160	160	160	160
Impulse voltage(V)	2500	2500	2500	1500	1500	1500	1500	1500
Overvoltage category	II							
Pollution Degree	III							

Contacts	Contact OD (mm)	Socket	Part No.	Contacts	Contact OD (mm)	Socket	Part No.
6A	2		M23-SSCSSTFS _x 06A	12A (Standard)	1		M23-SSCSSTFS _x 12A
7A	2		M23-SSCSSTFS _x 07A	12B (opposite)	1		M23-SSCSSTFS _x 12B
9A (8+1)	8		M23-SSCSSTFS _x 09A	17A (Standard)	1		M23-SSCSSTFS _x 17A
	1						
9B (8+1)	8		M23-SSCSSTFS _x 09B	17B (opposite)	1		M23-SSCSSTFS _x 17B
	1						
9C (6+3)	6		M23-SSCSSTFS _x 09C	19A (16+3)	16		M23-SSCSSTFS _x 19A
	3				2		
16A	1		M23-SSCSSTFS _x 16A				

Note: S_x refer to Flange joint

Remarks

- Please refer to Page 578 for the Conversion between American Wire Gauge AWG and Wire Cross-section mm².
- Please refer to Page 367 for products' part number encoding rule.